

TOPAZ

100% MAKE UP AIR

HEAT RECOVERY & HEAT PUMP



TRANSOM

MAKE UP AIR UNIT

Combines the natural efficiencies of the plate heat exchanger and the heat pump.



CAPACITIES
500 – 3200
CFM

4 MODELS

**MULTIPLE UNITS CAN BE
USED IN TANDEM FOR
GREATER CAPACITY**

MAIN FEATURES

- FLAT PLATE HEAT RECOVERY EXCHANGER
- REVERSING HEAT PUMP
- TWO STAGE SCROLL COMPRESSOR
- DUAL VARIABLE SPEED EC BLOWERS
- FULLY CHARGED AND FACTORY TESTED REFRIGERATION SYSTEM
- BUILT IN CONTROLS

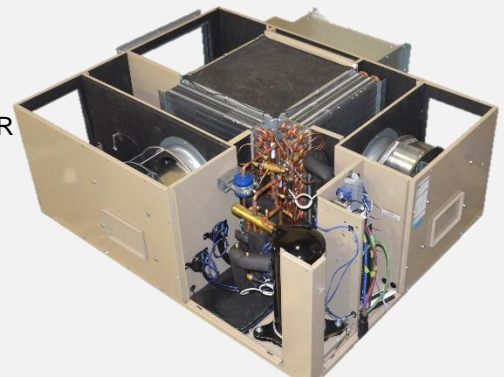

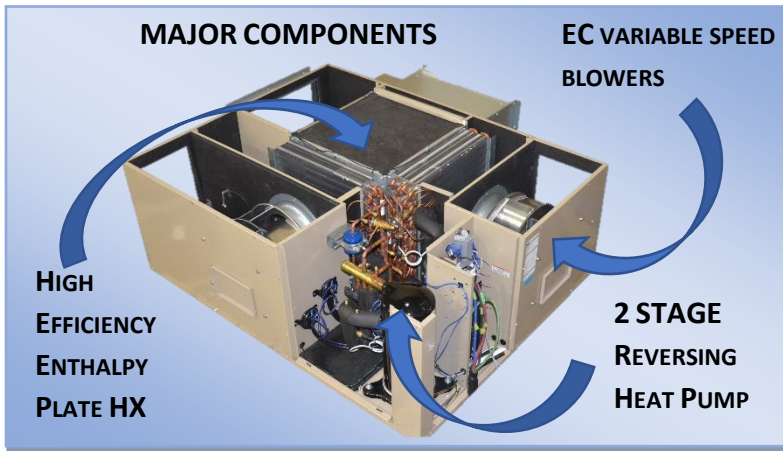

EC BLOWERS

Variable speed supply and exhaust blowers can be adjusted to match various back pressures and give a balanced air flow. Alternately it can be used to create **positive pressure** environment.

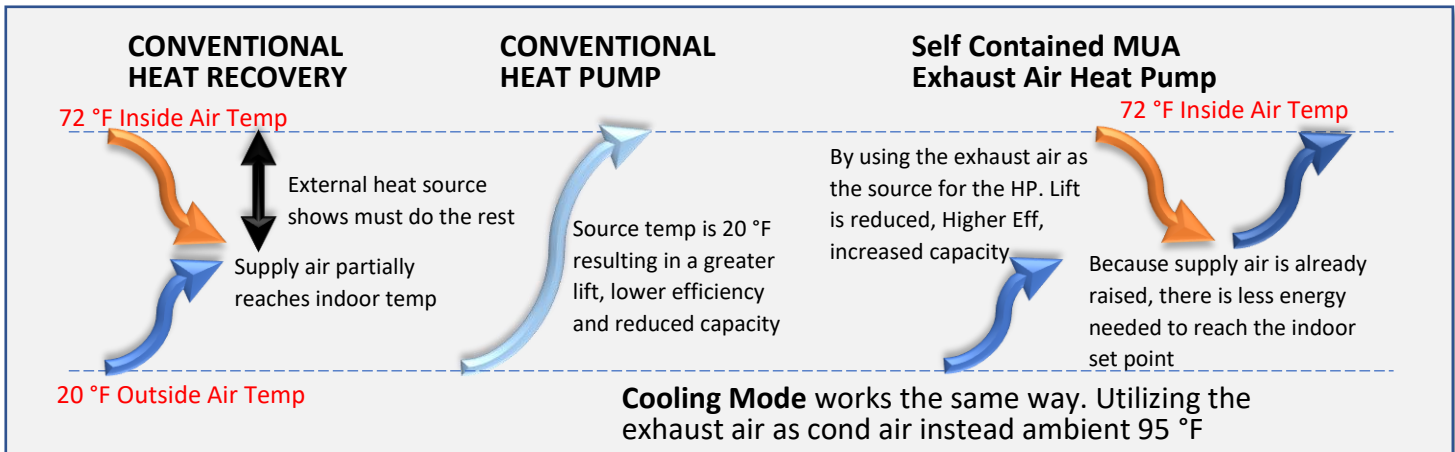

- REFRIGERANT CIRCUIT INCLUDES**
1. Compressor – Scroll 2 stage
 2. Tube and fin heat exchangers
 3. 4-way Reversing valve
 4. Bi-directional Filter/Drier
 5. Bi-directional TXV
 6. Sight glass

COOLING MODE

Condenser uses exhaust air which is lower temp than outside air

Supply air is pre-cooled by the heat recovery entering the evaporator

HEATING MODE

Heating mode uses exhaust air for heat source instead of outside cold air

Heat recovery increases the supply air temp from outside so HP does not have to do a full lift

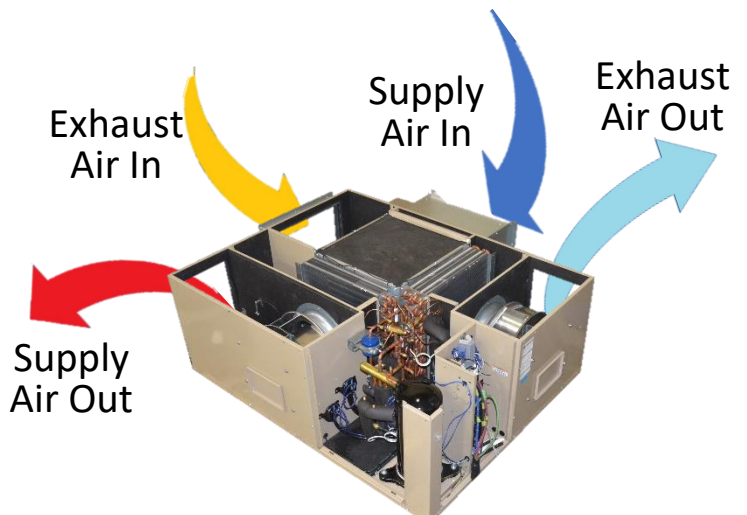
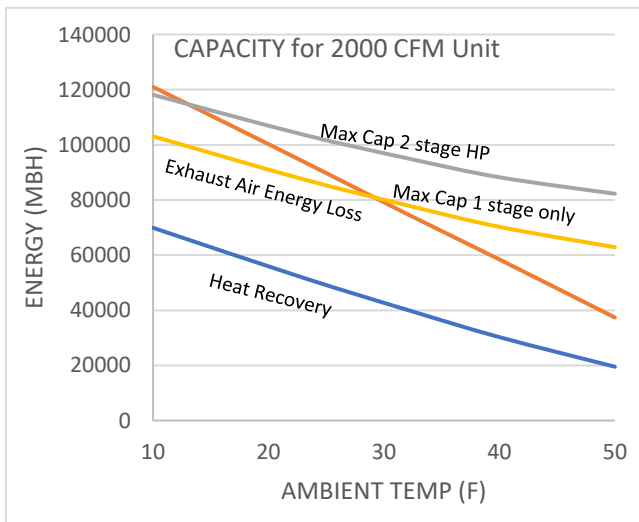



CEILING MOUNTED
WITH ONLY DUCTING, POWER
AND DRAIN TO CONNECT



LARGE ACCESS PANELS FOR SERVICE



NO SIZING OF COMPONENTS
NO REF CONNECTIONS
NO GAS CONNECTIONS

LOWER TEMP OPERATION
POSSIBLE BY USING FROST KIT

OPTIONS

FREE COOLING

- BYPASS HEAT RECOVERY HX WHEN AMBIENT PERMITS

BACK UP HEAT ATTACHMENT

- HYDRONIC
- ELECTRIC

Model		MHP05	MHP11	MHP20	MHP32
Air Flow	CFM	500	1100	2000	3200
Min Air Flow	CFM	390	858	1560	2500
Total Heat Capacity	MBH	33.6	71.6	126.1	203.7
COP		5.24	5.56	5.68	5.53
Recovery	%	112%	114%	115%	114%
Total Cooling Capacity	MBH	21.9	46	78.4	126.9
Unit EER		12.1	12.3	12.1	11.7
Recovery	%	1.08	1.08	1.08	1.07
External static – Supply	In wc	1.02	1.02	1.03	1.18
External static - Exhaust	In wc	0.99	0.98	0.93	1.17

Power Source		MHP05	MHP11	MHP20	MHP32
208-230/1/60		•	•	•	•
208-230/3/60			•	•	•
460/3/60			•	•	•
575/3/60			•	•	•

Dimensions		MHP05	MHP11	MHP20	MHP32
Length	In.	50.8	56.6	64.9	74
Width	In.	38	45.9	53.3	61
Height	In.	19.2	22.5	28.4	34.3

Summer Conditions Ambient 88F / 50% RH Winter Conditions Ambient 20F / 80% RH
 Interior 75F / 50% RH Interior 68F / 50% RH

APPLICATIONS

- Bars, restaurants and industrial kitchens
- Eliminate/reduce odors from retail stores, industrial labs
- Meeting rooms and lecture halls
- Exercise gyms, yoga studios, dance studios
- Industrial and commercial applications
- Retrofit facilities with dead/stagnant air flow areas
- Great for zoning, only have the air changes during occupancy periods
- Retrofit applications made easy. Provides air changes without affecting existing HVAC system balancing

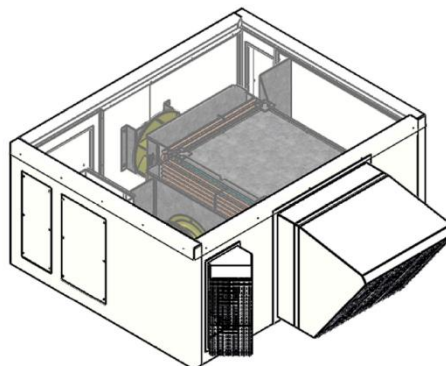
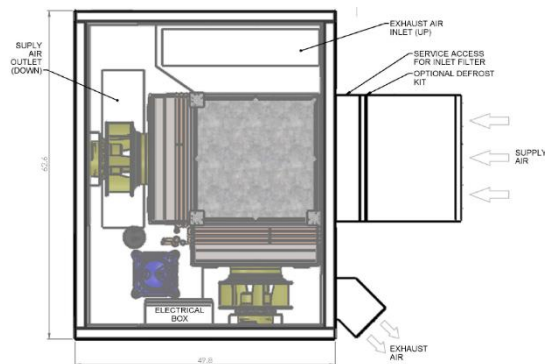

ROOF TOP VERSION

- Double wall
- 2" Insulation
- Sealed Service Doors
- Rain Guard
- Supply and Return connections from below
- Backward curved EC blowers

Other Products



TRENT CHILLER

- Capacities available from 2 to 8.5 ton
- Year-round operation
- Floating head pressure control
- 2 Stage scroll compressors
- Energy savings features
- Low temperature kit included
- Brazed Plate HX
- Built-in centrifugal pump
- Flow switch
- Swept fan blade design
- Variable speed fan
- Hydrophobic coated coil



LAMBERT CHILLER

- Capacities available in **20 to 80 ton**
- Up to 12 modules
- Redundancy N+1, N+2
- Capacity control
- High turn down
- Brazed plate heat exch.
- Water cooled
- Pre-made modular header
- Scroll compressors, dual circuit
- Smallest footprint

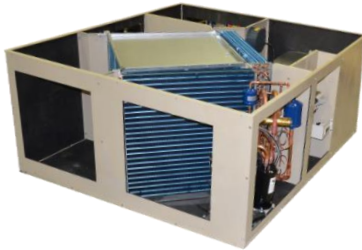

RAWSON CHILLER

- Capacities available from 10 to 80 ton
- Year-round operation
- 2 Stage control
- Energy saving features
- Low temperature kit included
- Brazed Plate HX
- Built-in centrifugal pump
- Flow switch
- Swept fan blade design

TOPAZ MHP

- Heat Recovery and Heat Pump unit
- 250- 3200 CFM
- Flat Plate HX recovers most of the heat
- Heat Pump generates higher heat
- EC backwards curved blowers
- Tube and fin heat pump coils
- Defrost accessories
- Indoor and Outdoor model



SEVERN WSHP

High Temp Water Sourced Heat Pump

- Capacities up to 600 MBH
- 180F Leaving Water Temp
- Operating range 30 to 110 F
- Cascade system
- Staged capacity
- Potable water or boiler
- Modular configuration
- Reversing
- Front serviceable



SIMCOE ASHP

CO2 High Temp Air Sourced Heat Pump

- Capacities up to 600 MBH
- 140F Leaving Water Temp
- Operating range -30 to 120 F
- Variable capacity
- Potable water to boiler
- Modular configuration
- Back up elec heater
- Integral Pump
- Reversing
- High static blower option



HATCH ASHP

High Temp Air Sourced Heat Pump

- Capacities up to 300 MBH
- 140F Leaving Water Temp
- Operating range -30 to 110 F
- Variable capacity
- Potable water to boiler
- Modular configuration
- Back up elec heater
- Integral Pump
- Reversing
- High static blower option